

1977 Property Tax Maps

MSA Series ID: SM125
(Online)

The screenshot shows the Maryland State Archives website. At the top, there is a banner with the Maryland State Archives logo and the text "WELCOME TO THE STATE ARCHIVES". Below the banner is a search bar with the placeholder text "Search the Archives" and a magnifying glass icon. A navigation menu is located below the search bar, with links for HOME, ABOUT, FIND RECORDS, MARYLAND HISTORY, DIGITAL RESOURCES, and ART & CULTURE. On the left side, there is a "Quick Links" section with a list of links: Visit the Archives, Guide to Government Records (highlighted with a red arrow), Government Agencies, Maryland Land Records, Maryland Manual Online, and Baltimore City Archives. On the right side, there is an announcement for a "Lunch & Learn" event on April 11, titled "Brothers in Arms: The Revolutionary Service of James and Edmund Brice by Glenn Campbell". The event details include the title, author, and a request to join the event.

Note: Keep in mind when viewing the maps you are actually looking at a roll of film. More than one county can be may be showing.

Maryland State Archives Guide to Government Records

Home Introduction Reference and Research How To Place An Order Background Advanced Search

Introduction

The Maryland State Archives is the central repository for state government records of permanent value. The Archives operates with a broad legal mandate to acquire and care for both public and private records relating to the history of Maryland from initial settlement in 1634 to the present.

The Guide to Government Records is the finding aid created to assist users in their search for particular records. The guide describes record series that have been created by state, county, and municipal agencies. Each record series has a unique identification number. State records are identified by the prefix S, county records by the prefix C, municipal records by the prefix M, and transfer records (see below) by the prefix T.

Records can be grouped and sorted in three ways: by series, by agency, and by record type.

Please see the [introduction tab](#) for tips on making your search as resourceful as possible.

Once you have selected a display type, you can refine your search using filter criteria. For example, you can select a specific category, choose a record series such as land records, specify paper or microfilm or electronic records only, or choose all the records of a particular agency. Filter criteria can be combined to refine your search.

Choose Your Display Type

Display by Series

Series consist of similar records created by one or more levels of government and agencies. Birth records, muster rolls, land records, assessments records, marriage licenses, and court proceedings are just a few examples of record series.

[View By Series](#)

Jump to Series By ID

Series ID

SM125

[Jump to Series](#)

Examples of valid series IDs are BRG1-1, C55, SM27, TM18.

	Date	Book Name	Film Reels	Description	Links	MSA Citation
Details	07/1977		SR 2361-1 (Scanned)	Allegany	Additional Links	SM125-1
Details	12/1977		SR 2361-2 (Scanned)	Anne Arundel	Additional Links	SM125-2
Details	11/1977		SR 2361-3 (Scanned)	Baltimore	Additional Links	SM125-3
Details	12/1977		SR 2362-1 (Scanned)	Calvert	Additional Links	SM125-4
Details	12/1977		SR 2362-2 (Scanned)	Caroline	Additional Links	SM125-5
Details	07/1977		SR 2362-3 (Scanned)	Carroll	Additional Links	SM125-6
Details	04/1977		SR 2362-4 (Scanned)	Cecil	Additional Links	SM125-7
Details	12/1977		SR 2363-1 (Scanned)	Charles	Additional Links	SM125-8
Details	01/1978		SR 2363-2 (Scanned)	Dorchester	Additional Links	SM125-9
Details	10/1977		SR 2363-3 (Scanned)	Frederick	Additional Links	SM125-10
Details	09/1977		SR 2363-4 (Scanned)	Frederick City (contd.)	Additional Links	SM125-11
Details	09/1977		SR 2364-1 (Scanned)	Frederick City	Additional Links	SM125-12
Details	01/1978		SR 2364-2 (Scanned)	Garrett	Additional Links	SM125-13
Details	06/1977		SR 2364-3 (Scanned)	Harford	Additional Links	SM125-14
Details	02/1978		SR 2364-4 (Scanned)	Howard	Additional Links	SM125-15
Details	09/1977		SR 2364-5 (Scanned)	Kent (contd.)	Additional Links	SM125-16
Details	09/1977		SR 2365-1 (Scanned)	Kent	Additional Links	SM125-17
Details	09/1977		SR 2365-2 (Scanned)	Montgomery	Additional Links	SM125-18
Details	12/1977		SR 2366-1 (Scanned)	Prince George's	Additional Links	SM125-19
Details	11/1976		SR 2366-2 (Scanned)	Queen Anne's	Additional Links	SM125-20
Details	02/1977		SR 2366-3 (Scanned)	St. Mary's	Additional Links	SM125-21
Details	12/1977		SR 2366-4 (Scanned)	Somerset	Additional Links	SM125-22
Details	10/1977		SR 2367-1 (Scanned)	Talbot	Additional Links	SM125-23
Details	11/1977		SR 2367-2 (Scanned)	Washington	Additional Links	SM125-24
Details	12/1977		SR 2367-3 (Scanned)	Wicomico	Additional Links	SM125-25
Details	12/1977		SR 2368 (Scanned)	Worcester	Additional Links	SM125-26

	Date	Book Name	Film Reels	Description	Links	MSA Citation
Details	07/1977		SR 2361-1 (Scanned)	Allegany	Additional Links	SM125-1
Details	12/1977		SR 2361-2 (Scanned)	Anne Arundel	Additional Links	SM125-2
Details	11/1977		SR 2361-3 (Scanned)	Baltimore	Additional Links	SM125-3
Details	12/1977		SR 2362-1 (Scanned)	Calvert	Additional Links	SM125-4
Details	12/1977		SR 2362-2 (Scanned)	Caroline	Additional Links	SM125-5
Details	07/1977		SR 2362-3 (Scanned)	Carroll	Additional Links	SM125-6
• e-publication 						
Details	04/1977		SR 2362-4 (Scanned)	Cecil	Additional Links	SM125-7
Details	12/1977		SR 2363-1 (Scanned)	Charles	Additional Links	SM125-8
Details	01/1978		SR 2363-2 (Scanned)	Dorchester	Additional Links	SM125-9
Details	10/1977		SR 2363-3 (Scanned)	Frederick	Additional Links	SM125-10
Details	09/1977		SR 2363-4 (Scanned)	Frederick City (contd.)	Additional Links	SM125-11
Details	09/1977		SR 2364-1 (Scanned)	Frederick City		SM125-12
Details	01/1978		SR 2364-2 (Scanned)	Garrett		SM125-13
Details	06/1977		SR 2364-3 (Scanned)	Harford		SM125-14
Details	02/1978		SR 2364-4 (Scanned)	Howard		SM125-15
Details	09/1977		SR 2364-5 (Scanned)	Kent (contd.)		SM125-16
Details	09/1977		SR 2365-1 (Scanned)	Kent	Additional Links	SM125-17
Details	09/1977		SR 2365-2 (Scanned)	Montgomery	Additional Links	SM125-18
Details	12/1977		SR 2366-1 (Scanned)	Prince George's		SM125-19
Details	11/1976		SR 2366-2 (Scanned)	Queen Anne's		SM125-20
Details	02/1977		SR 2366-3 (Scanned)	St. Mary's		SM125-21
Details	12/1977		SR 2366-4 (Scanned)	Somerset		SM125-22
Details	10/1977		SR 2367-1 (Scanned)	Talbot	Additional Links	SM125-23
Details	11/1977		SR 2367-2 (Scanned)	Washington	Additional Links	SM125-24
Details	12/1977		SR 2367-3 (Scanned)	Wicomico	Additional Links	SM125-25
Details	12/1977		SR 2368 (Scanned)	Worcester		SM125-26



Map Number Index Page

Click on Enlarge and print image. PDF image will load. Zoom in or out as needed

Note: Jump to page function does not match the page numbers
(Map page numbers are located in the bottom right corner)

Maryland State Archives
DEPARTMENT OF ASSESSMENTS AND TAXATION
MAP DIVISION
(Tax Map)
msa_sm125_sr2362-0271
Enlarge and print image (3M) View Transcript Transcribe

Jump to page

<< PREVIOUS NEXT >>

271-Current Page Number

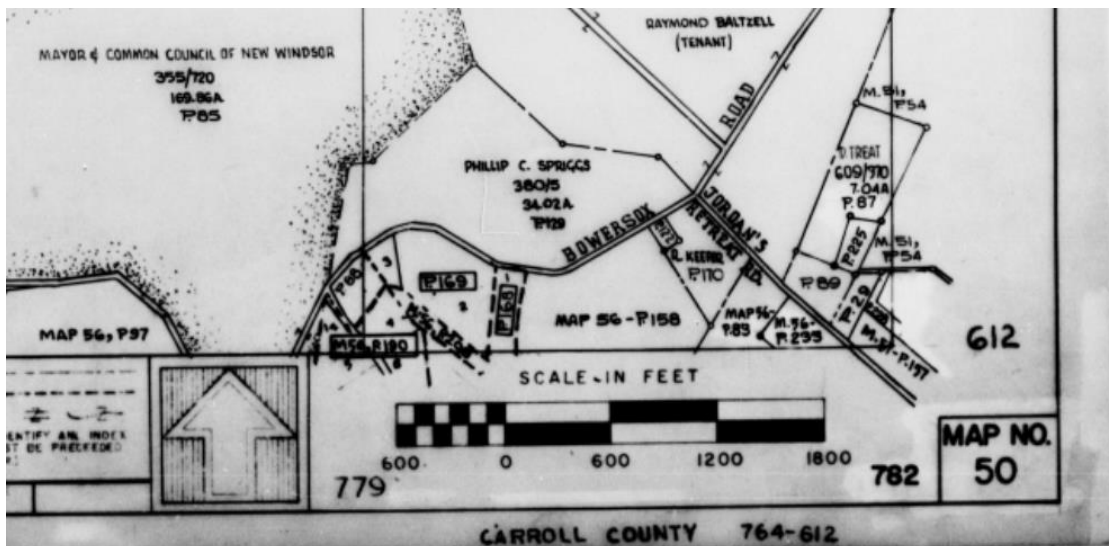
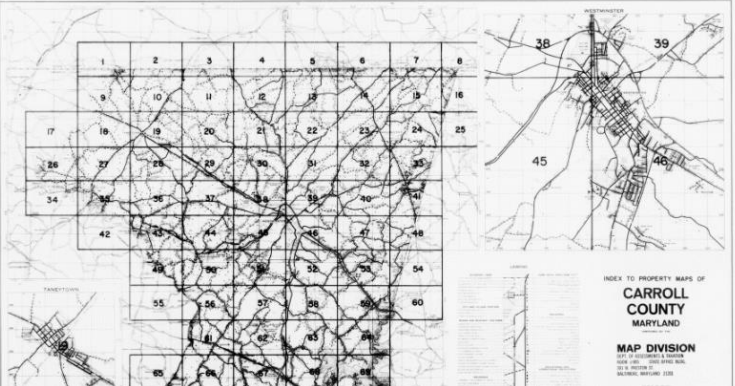

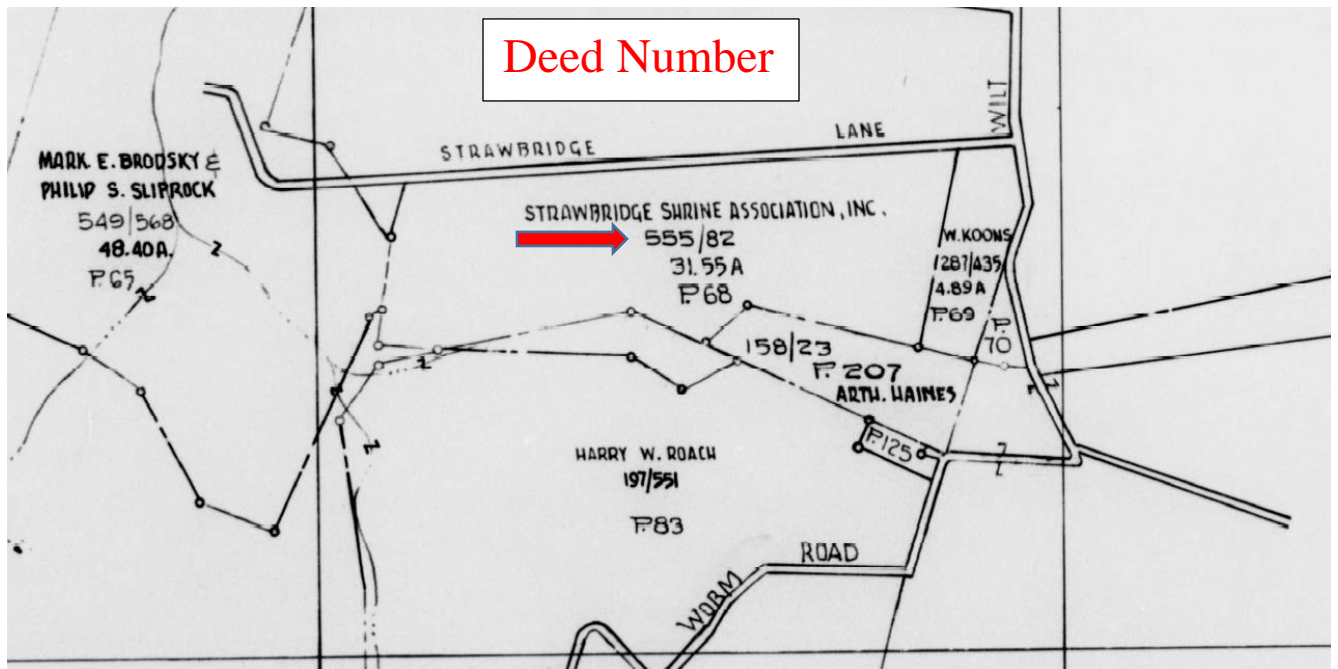

31.55 (Acres)

P. 68 (Parcel 68)

Note: Map page numbers remain the same to the present day,
deed and parcel numbers can change